

HEAVY DUTY SHEAVES- CAST, FORMED AND WELDED



Miller Heavy Duty Sheaves are available in **cast alloy steel or formed and fabricated carbon steel.**

Miller Hi-Lift Blocks are furnished standard with cast alloy steel sheaves.

Cast alloy steel sheaves are available in standard sizes from 8" to 36" in diameter and are listed in the succeeding table.

Cast sheaves weighing up to 4 tons and to 120" diameter are available to your requirements. **Roll-formed sheaves** are produced to your requirements up to 130" in diameter. See the sheave request for quotation form in this section and

specify cast or formed, or include your drawing.

All sheaves can be manufactured to accommodate special requirements (e.g., API, ABS).

Heavy Duty Cast Sheaves

Miller Hi-Lift Blocks are furnished standard with cast alloy steel sheaves of Miller's unique design. Wire rope grooves in Miller cast sheaves are precision machined at a 30° included angle and for the specific wire rope size maximizing wire rope life.

Miller cast alloy steel sheaves are available from 8" to 36" outside diameter as follows:

1. With tapered (24" and larger) or cylindrical roller (20" and smaller) bearings
2. With SAE 660 bronze bushings
3. Finish-bored without bushing or bearing
4. Stainless steel casting in any of the above three configurations (please inquire)

When ordering sheaves, please specify outside diameter, rope size, and configuration.

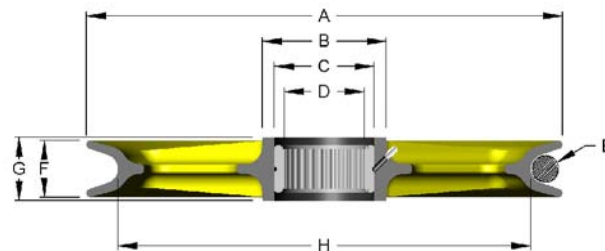

SIZE (in.)	Rope Size	A	B	C	D	F	G	H	Weight Lbs.
8	7/16, 1/2	8.00	3	2.19	1.63	1.13	1.25	6.63	7
10	1/2, 9/16	10.00	3	2.19	1.63	1.13	1.25	8.5	10.25
12	1/2, 9/16, 5/8	12.00	4	3.25	2.50	1.44	2.00	10.13	21
14	1/2, 9/16, 5/8, 3/4	14.00	4	3.25	2.50	1.75	2.00	11.63	24
16	9/16, 5/8, 3/4	16.00	5.25	3.75	3.00	2	2.38	13.25	31
18	3/4, 7/8, 1	18.00	4.63	3.75	3.00	2.125	2.38	15.5	41
18BP	5/8, 3/4, 7/8, 1	18BP	5.25	4.25	3.25	1.88	2.00	15.75	41
20	3/4, 7/8, 1, 1-1/8	20.00	5.25	4.5	3.50	2.14	2.50	17.25	48
20	3/4, 7/8, 1, 1-1/8	20.00	5.25	4.25	3.25	2.14	2.50	17.25	48
24	7/8, 1, 1-1/8	24.00	7.38	6	3.50	2.75	3.56	20.88	83
30	1-3/8, 1-1/2	30.00	8	7.19	5.00	3	3.63	25.63	152
36	1-3/8, 1-1/2	36.00	10	7.19	5.00	3	3.63	31.63	230

- For 24" sheaves please specify hub width and bore; for 20" sheaves specify shaft size

HEAVY DUTY SHEAVES- CAST, FORMED AND WELDED

Custom Sheaves

Miller has been providing **custom sheave solutions** for many years to a variety of industries including; marine, energy, construction and heavy industrial. Depending on your requirements, both cast and roll-formed sheaves can be provided. Special requirements such as API, ABS or others can be accommodated. Miller has the expertise in design and analysis to help you in your design efforts.

Cast sheaves are available to 4 tons gross weight and 120 inches in diameter from most any alloy or stainless steel material FOR BOTH, WIRE ROPE AND/OR CHAIN.

Roll-formed sheaves are available up to 130 inches in diameter and are manufactured from low carbon steel plate and forged hubs.

Following are a few samples of the variety of custom sheaves recently provided by Miller. Please fill in the form on the following page, call or send us your drawing for our quotation.



HEAVY DUTY SHEAVES- CAST, FORMED AND WELDED

REQUEST FOR QUOTATION

Name _____ Company _____ Date _____

Address _____

Telephone _____ Fax _____ E-mail _____

1. Specify type & quantity: Cast _____ Roll-formed _____ Quantity _____

2. Specify dimensions:

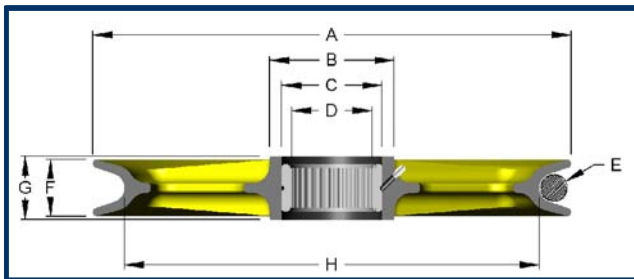

Outside diameter (A)	
Tread diameter (H)	
Shaft diameter (D)	
Rim width max (F)	
Hub O.D. (B)	
Hub Width (G)	
Hub bore dia. (C)	
Rope or chain size (E)	

3. Specific bearing type:

None, plain bore _____ Roller _____ Tapered roller _____ Composite _____ Bronze _____

4. Specify where applicable:

Base material _____ Finish _____

To industry standard _____

Special testing _____

Groove hardness _____ Third party inspection _____

Other _____

5. Fax, call or e-mail to:

Miller Products
 100A Sturbridge Rd.
 Charlton, MA 01507 USA

Tel 1.508.248.3941 / 800.733.7071
 Fax 1.508.248.0639
 E-mail info@millerproducts.net